



Eric Street, London, E3

BUTLER & STAG



Excellent one bedroom top floor modern apartment close to Mile End underground station.



- One Bedroom Apartment
- Private Balcony with Expansive Views
- Modern Kitchen and Bathroom
- Unfurnished
- Top Floor
- Excellent Condition Throughout
- Close to Mile End Station
- Available from 17th January 2025

Set within a secure development on a residential street, the property features a wonderful open-plan kitchen/reception space which opens out onto a private balcony with expansive city views. Further comprising of a generous double bedroom, stylish bathroom and a handy hallway storage cupboard, the apartment is well-presented throughout and includes an entry phone system.

Conveniently located, Mile End underground station, Mile End Park and the canal are all in close proximity. Surrounded by plenty of local amenities and with straightforward access to Canary Wharf, this is the perfect East London base for a single professional or couple.

Offered unfurnished and available from 17th January 2026.

EPC Rating C
Council Tax Band C





Reid Buildings

Approx. Gross Internal Area 51.1 Sq M (549.6 Sq Ft)

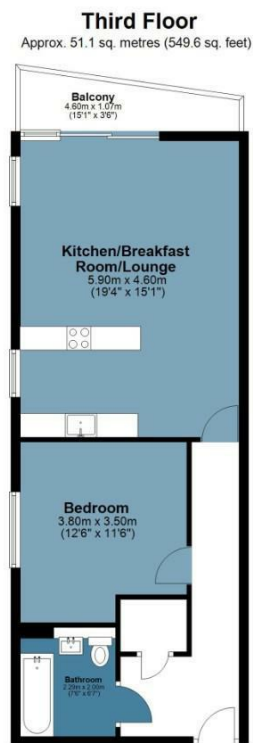

Measurements are approximate and for illustration purposes only. While we do not doubt the accuracy and completeness, we advise you conduct a careful independent assessment of the property to determine monetary value.
© @modephotouk www.modephoto.co.uk

BUTLER & STAG



BUTLER & STAG

☎ 020 8102 1236

🏠 508 Roman Road, Bow, London, E3 5LU

✉ bow@butlerandstag.com

www.butlerandstag.uk

IMPORTANT NOTICE - These particulars have been prepared in good faith and they are not intended to constitute part of an offer or contract. We have not performed a structural survey on this property and the services, appliances and specific fittings have not been tested. All photographs, measurements, floor plans and distances referred to are given as a guide and should not be relied upon.